

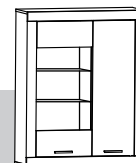

www.MLMEBLE.pl

GB D CZ SK AUS LT
assembly instructions / montageanleitung / montážní návod / montážny návod / инструкции по монтажу / surinkimo instrukcija



INSTRUKCJA MONTAŻU

MODERN 14

↑116 →92 ↗31

akcesoria / accessories / zubehör / příslušenství / príslušenstvo / аксессуары / furnitūra :

x 16 KK 8/32	x 36 MD	x 16 ZAM	x 20 GZ 1,4/25	x 8 PO Ø5	x 8 PA Ø5	x 8 WT 3,5x16	x 10 WT 4x30	x 4 ZPR	x 4 PK H-2	x 8 SP
x 7 BDP	x 2 UT 1.151	x 6 TD 01	x 6 WE 6,3x16 ES	x 3 ZAR	x 3 ZWA	x 8 WE 6,3x13	x 1 klej / glue / kleber / lepido / lepidlo / клей / kljaj			

do montażu potrzebne są:
are needed for assembly:
sind erforderlich für die montage:
jsou potřebné pro montáž:
sú potrebné pre montáž:
которые необходимы для сборки:
Surinkimui reikės:

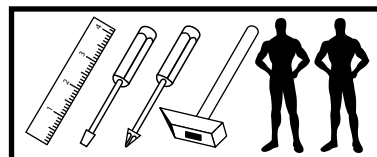

UWAGA! - w pierwszej kolejności wbijamy akcesoria „KK” i „MD” w blaty oraz boki.
WARNING! - The first accessory sticks "KK" and "MD" in the tops and sides.
WARNUNG! - Die erste Accessoire-Sticks "KK" und "MD" in den Spitzen und an den Seiten.
POZOR! - První příslušenství holí "KK" a "MD" v korunách a boky.
POZOR! - Prvé príslušenstvo palíc "KK" a "MD" v korunách a boky.
ВНИМАНИЕ! - Первый аксессуаров палочки "KK" и "MD" по вершинам и по бокам.
DĚMESIO! - Pirmiausiai furnitūrą KK ir MD įkalame į stalviršį ir šonus.

Nr/No	Szt/Qty
1	1
2	1
3	1
4	1
5	2
6	1
7	1
8	2
9	2
10	1
11	2
12	2
13	1
14	2

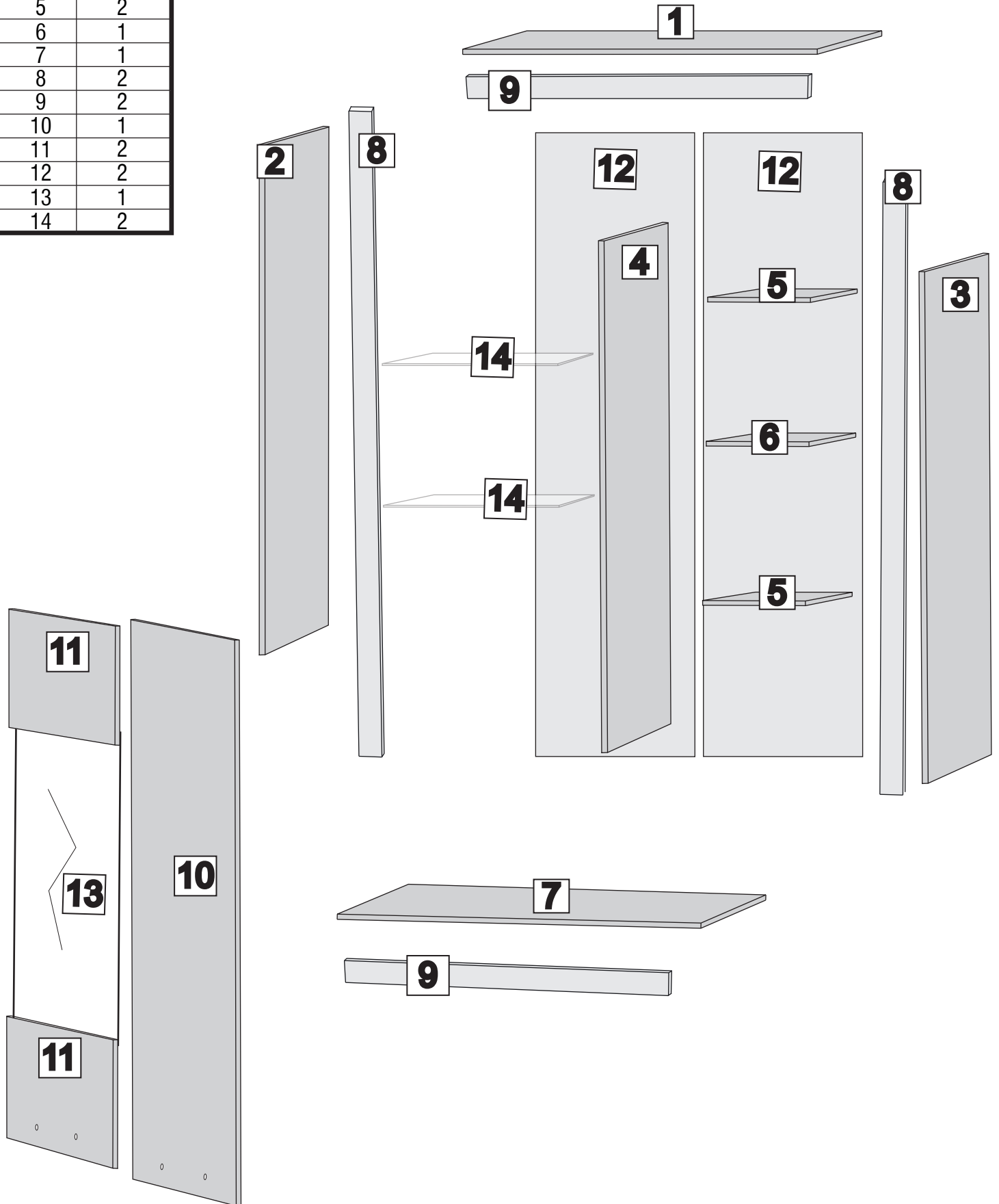

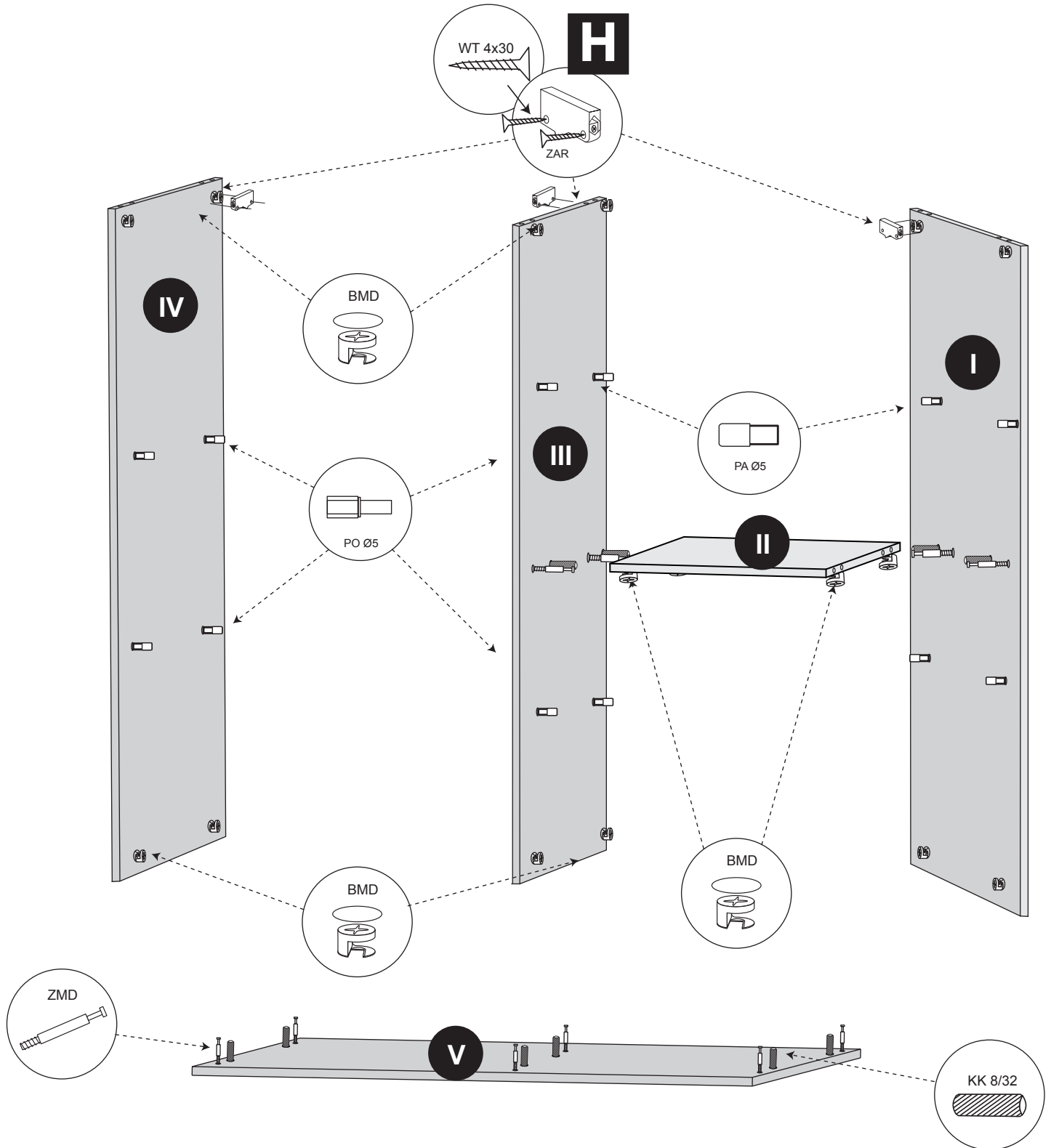
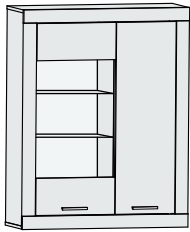

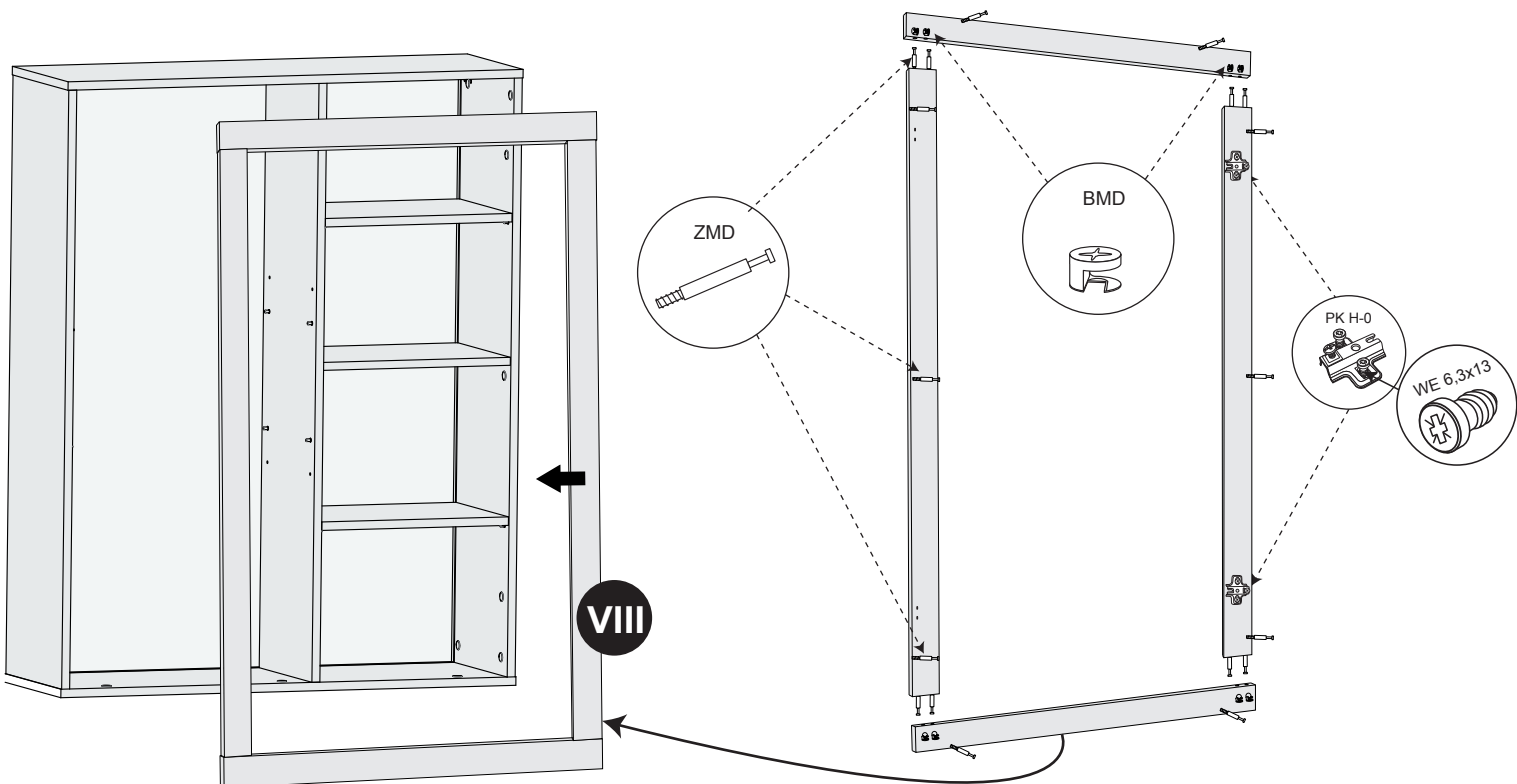
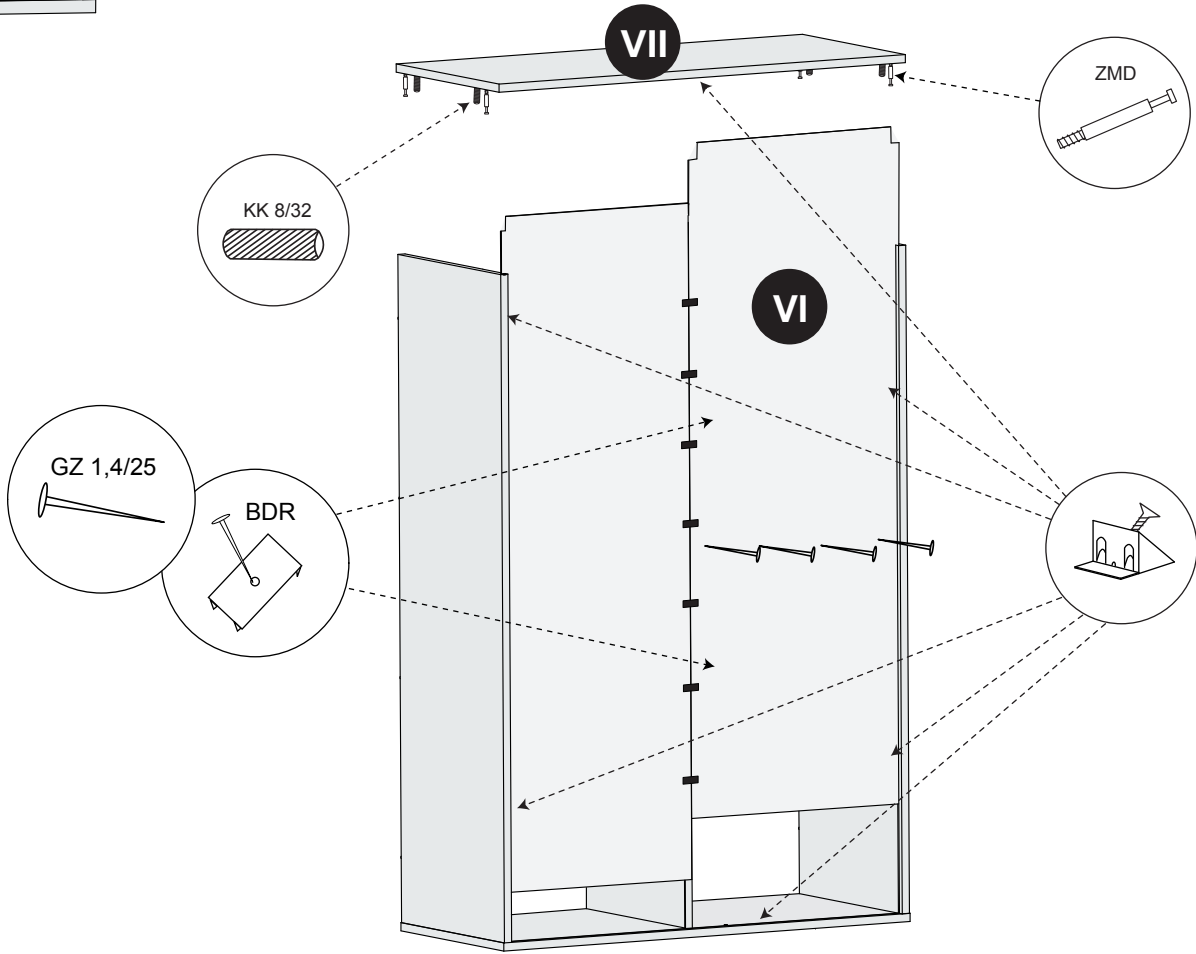
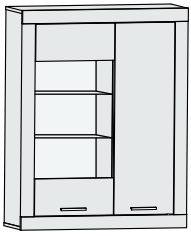

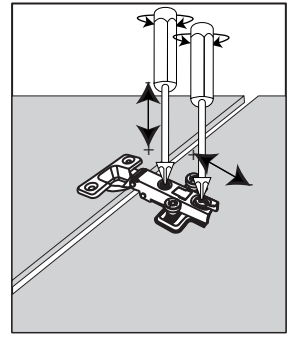
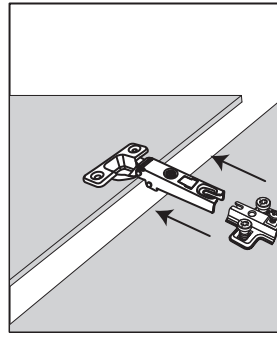
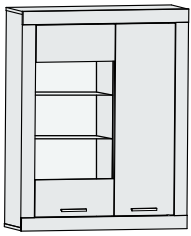

A

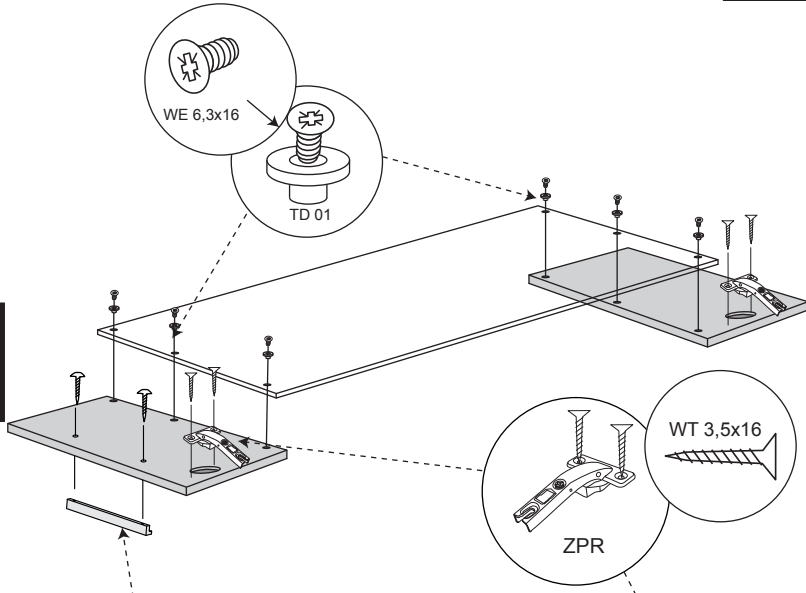

B

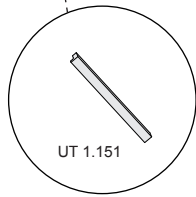
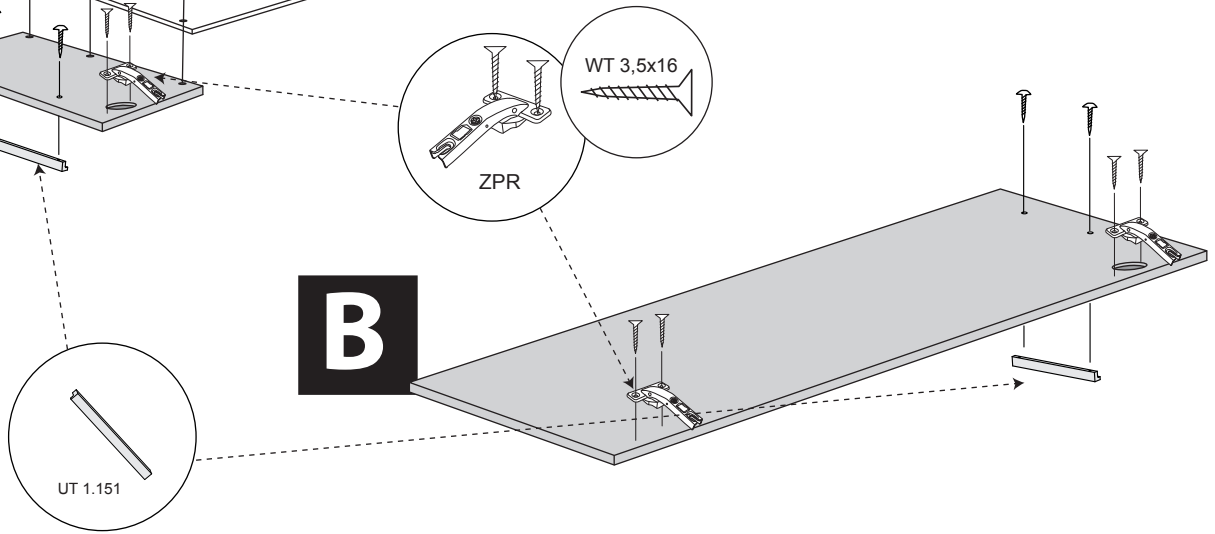

H

