

# HiHOT

# S193-KOM2D1S

A	B	C	D	A	B	C	D		
1	S193-002	764	200	4/4	9	S193-401	770	60	2/4
2	S193-003	606	380	4/4	10	S193-402	770	60	2/4
3	S193-004	606	380	4/4	11	S193-403	721	161	4/4
4	S193-103	977	400	1/4	12	S193-901	858	813	1/4
5	S193-104	977	400	1/4	13	S193-903	743	330	2/4
6	S193-301	770	380	2/4	14	ZS3-5554	721	120	2/4
7	S193-310	769	364	2/4	15	ZT5-501	350	120	1/4
8	S193-316	770	380	2/4	16	ZT5-502	350	120	1/4

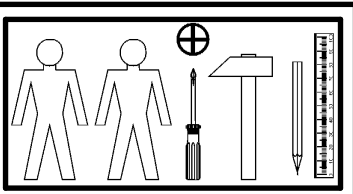
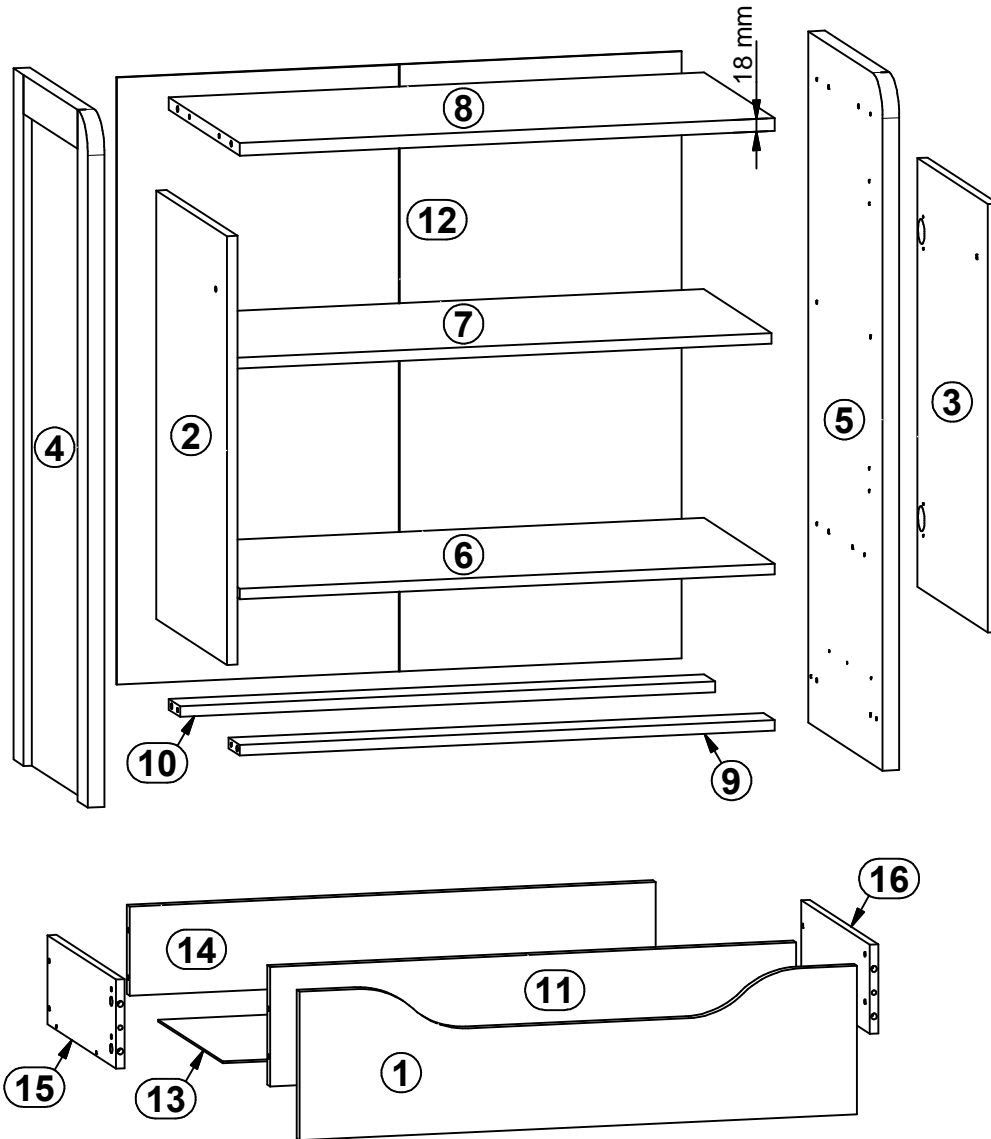
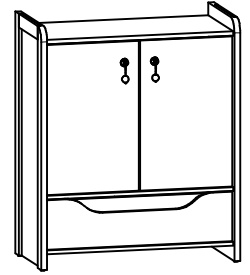

4x  a43	4x  b38	2x  c353/1	4x  d1	8x  e13	10x  e19	8x  f25	14x  f9	2x  j83
4x  k1	45x  l1	14x  p38	8x  p51	12x  r1	4x  r15	16x  r16	1x  w45/CL	1x  w45/CR
1x  w45/DL	1x  w45/DR	1x  n26/1	1x  p38					

1 

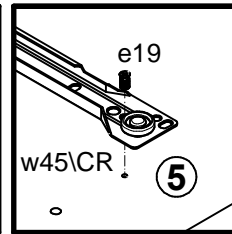
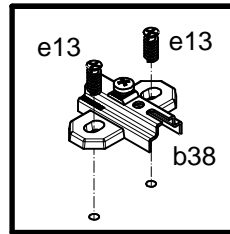
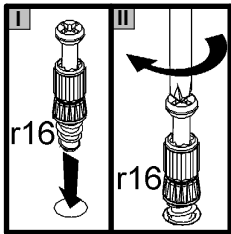
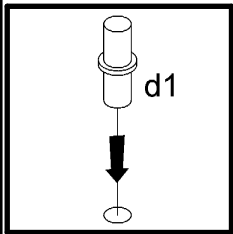
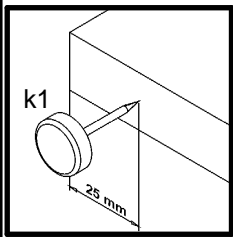
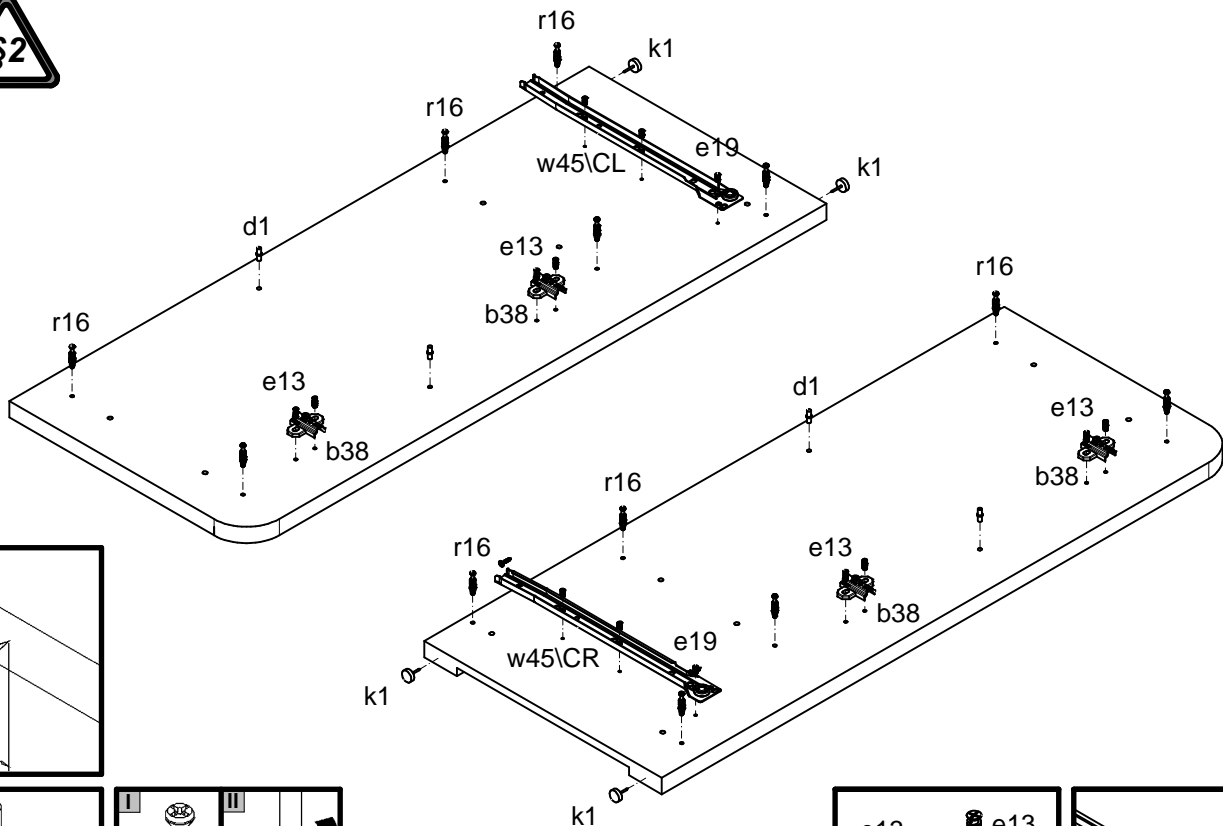

2 

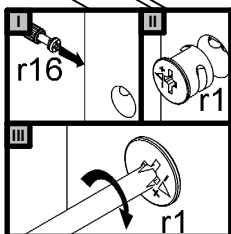
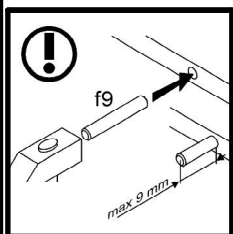
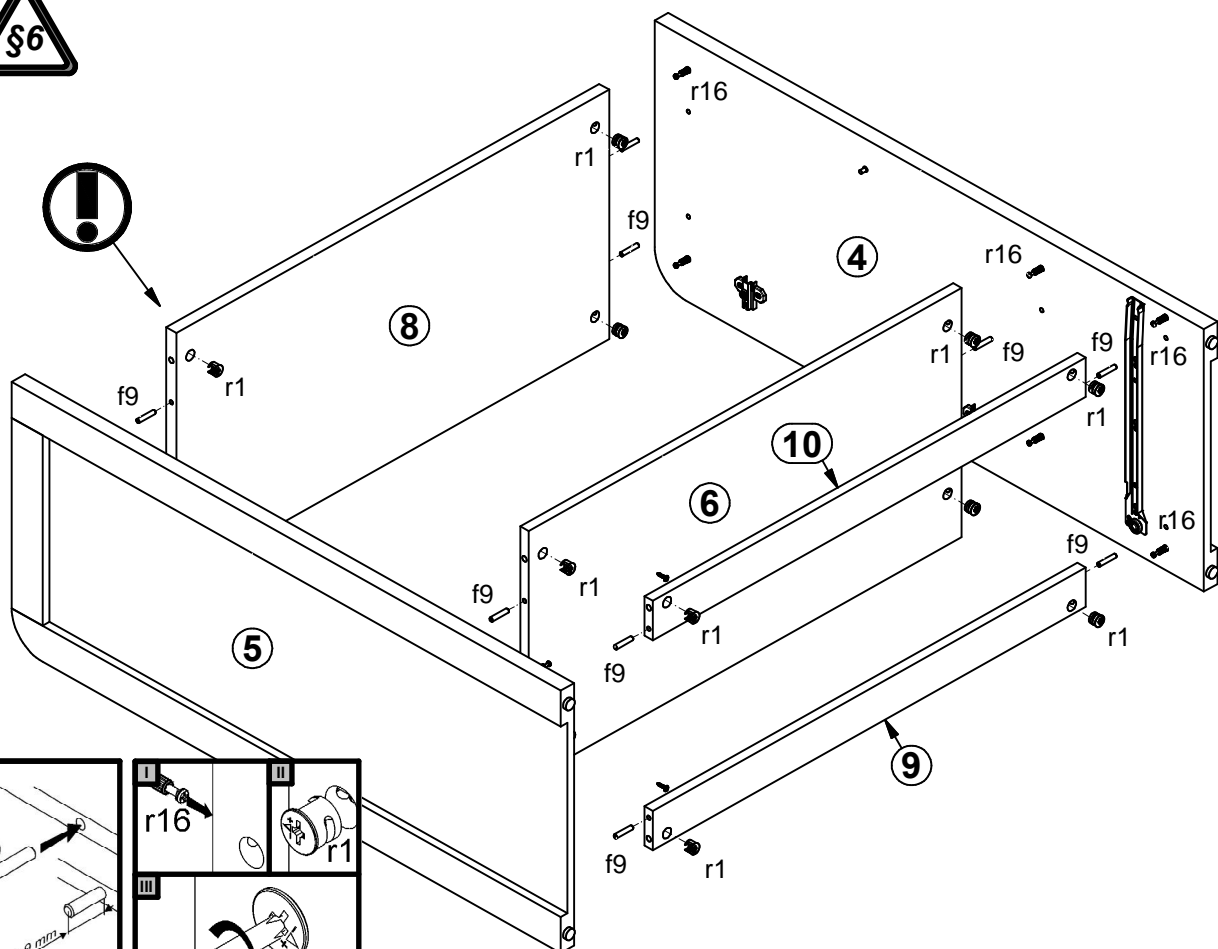

# 3

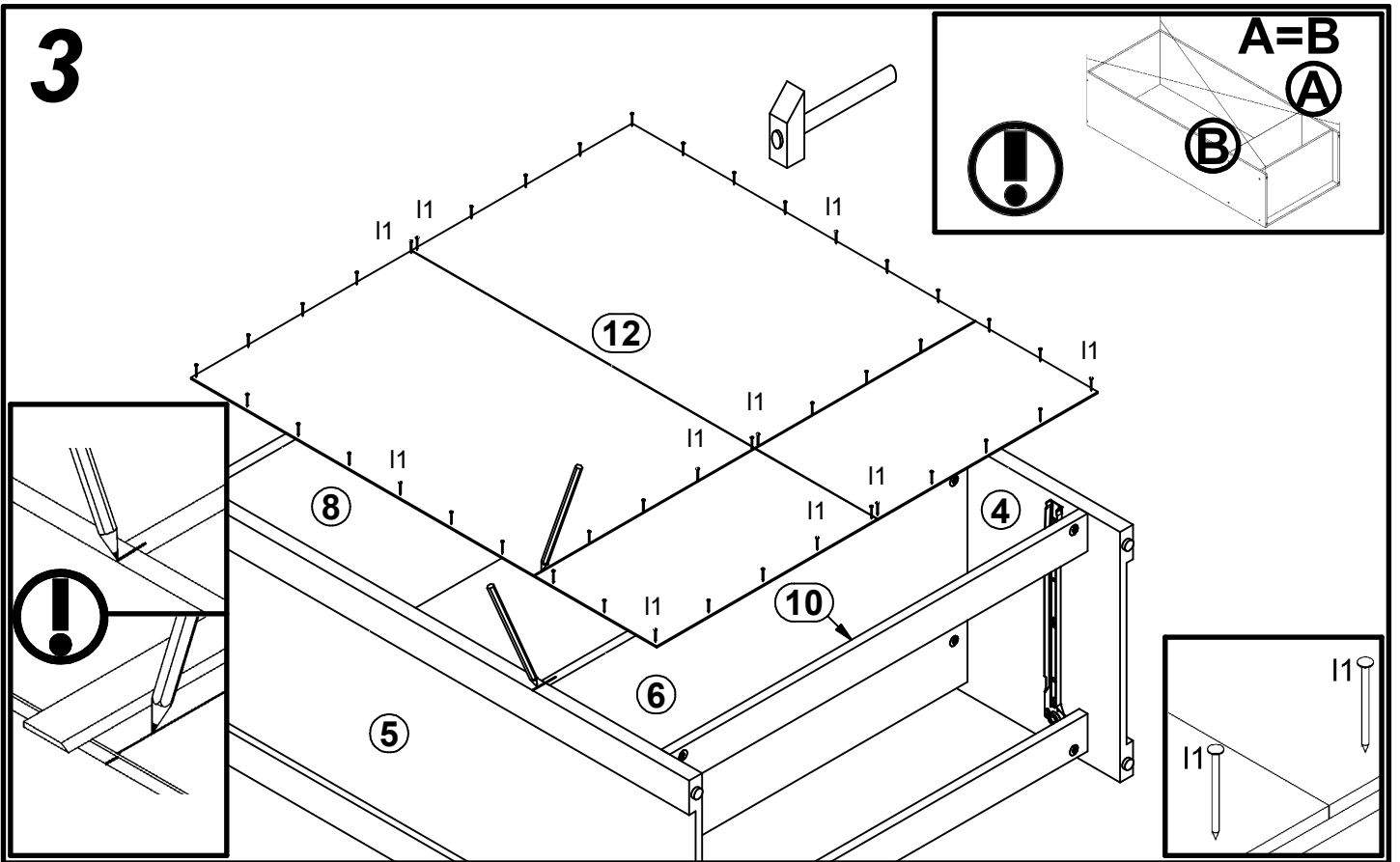

# 4

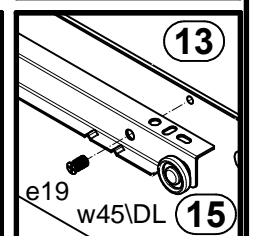
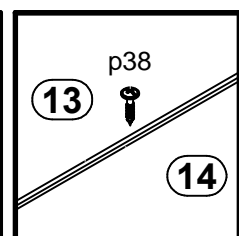
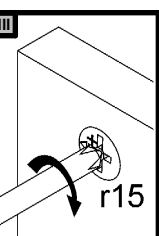
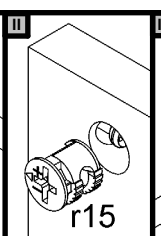
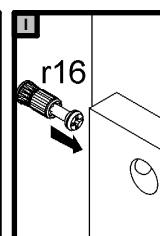
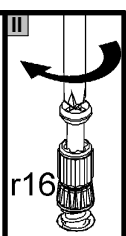
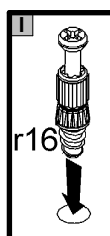
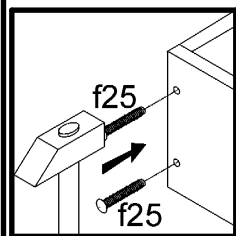
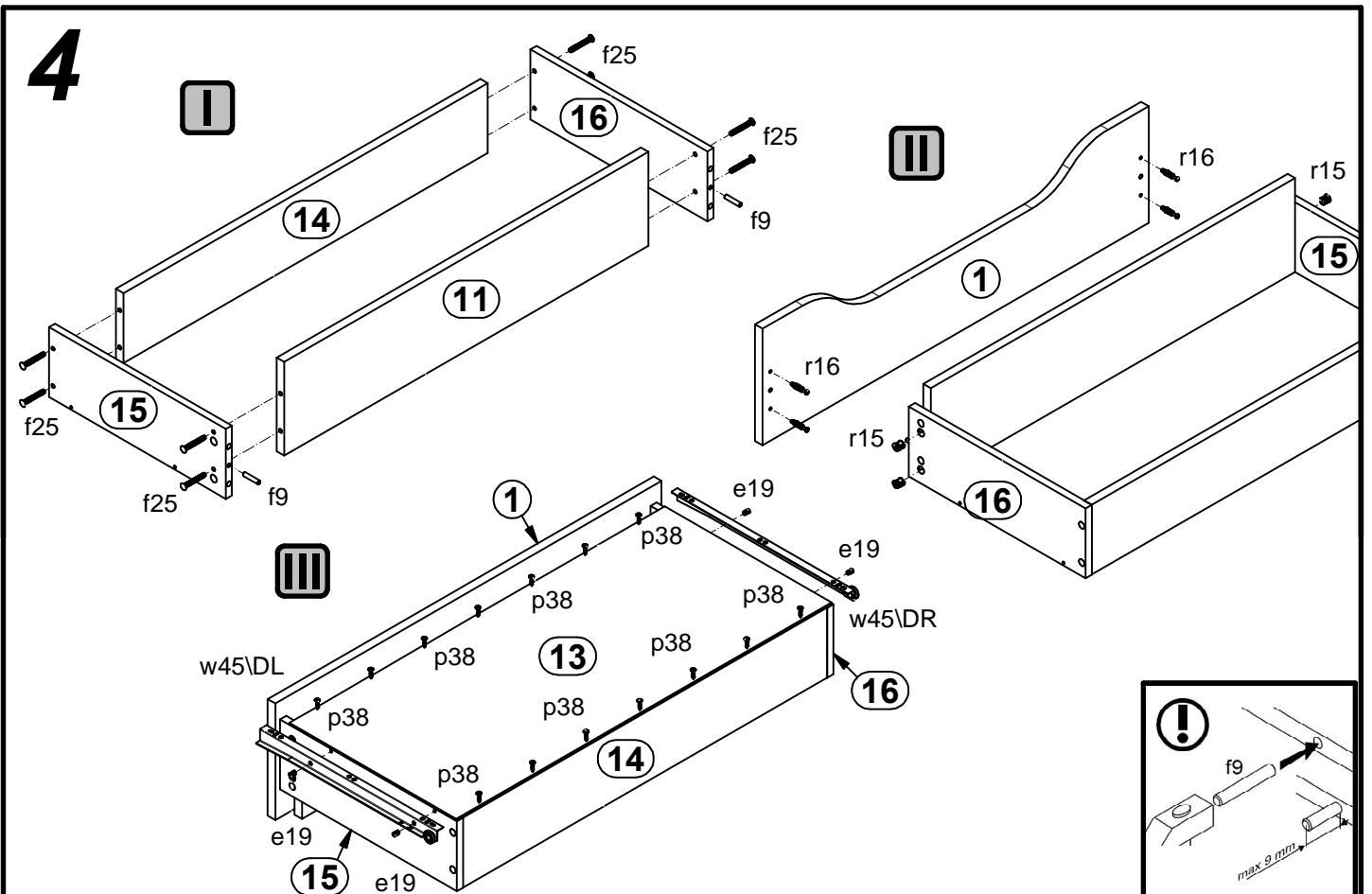

# 5

